

# How to use driver adapter for Military Rifle Muzzle Crowning Tool Kit

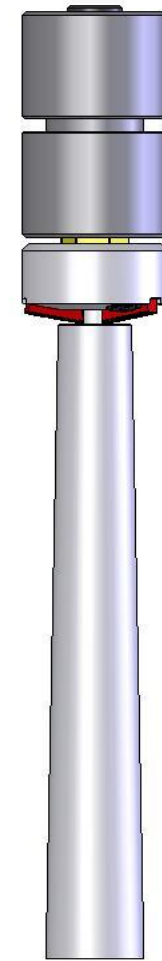
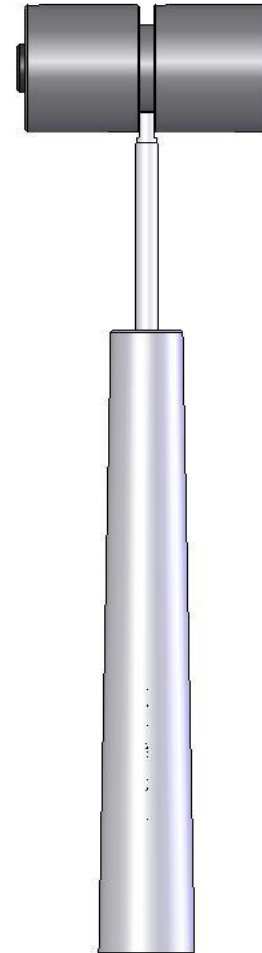
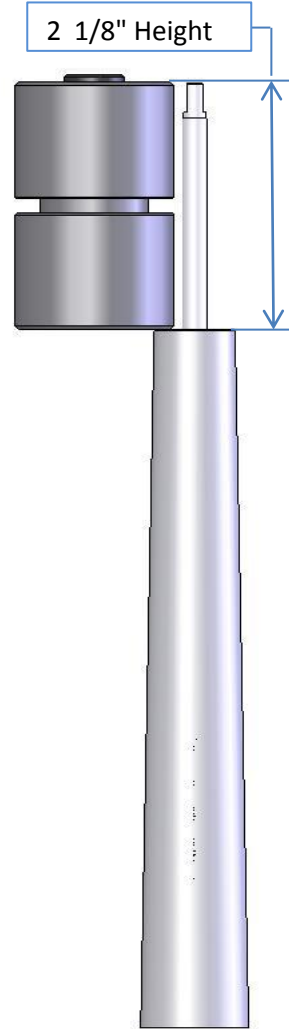

Step #1. Select the cutter pilot appropriate for the barrel bore, then insert cutter pilot into the barrel bore

Step #2. Use driver adapter body as a height gauge to establish required pilot protrusion from the barrel bore

Step #3. Use 1/8" wide groove on the outside of driver adapter body to engage pilot flats and to tighten the pilot

Step #4. Mount muzzle crowning cutter onto the pilot, then carefully slide down to contact barrel muzzle

Step #5. Mount driver adapter as shown. Use power driver ONLY with included or your own 1/4" BALL END hex bit.

**Use electric screwdriver or low RPM hand held drill. Never use more than 300 RPM to avoid damage to the cutter blades. Recommended RPM range: 75-225.**